

MAGPRO 75/4s

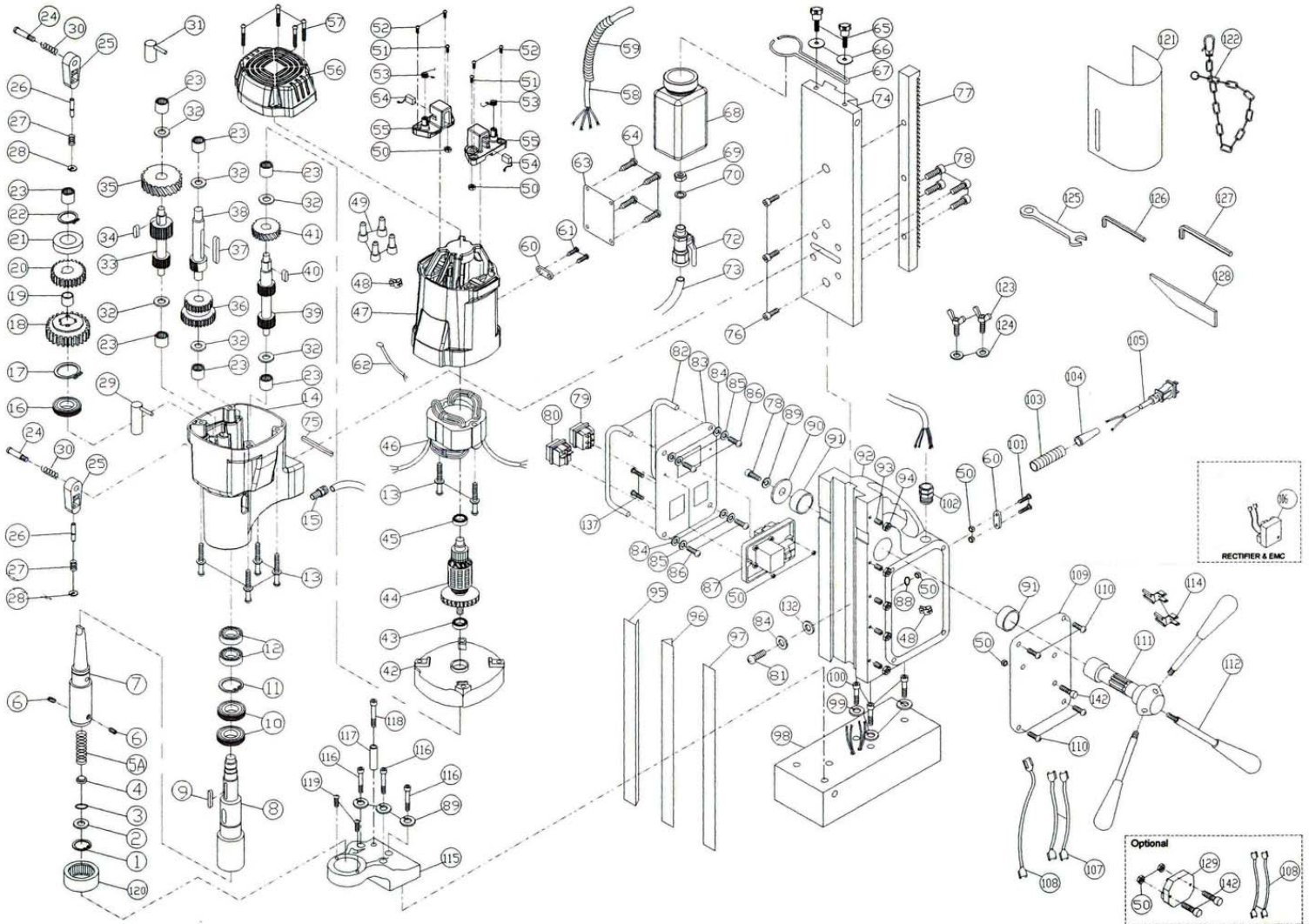

MAGPRO 75/4s

NO	Article Number	PARTS NAME		Q'TY
1	MA7501	INTERNAL CIR CLIP	R-19	1
2	MA7502	ARBOR WASHER		1
3	MA7503	RING	12*4	1
4	MA7504	WATER SEAL		1
5	MA7505	SPRING		1
6	MA7506	SET SCREW	M8*6	2
7	MA7507	MT3 ARBOR		1
8	MA7508	SPINDLE		1
9	MA7509	WOODRUFF KEY	5*5*40	1
10	MA7510	OIL SEAL	40*55*7	2
11	MA7511	INTERNAL CIR CLIP	R-55	1
12	MA7512	BEARING	6006zz	2
13	MA3514	SCREW	M5*60	6
14	MA7514	GEAR CASE		1
15	MA3516	COOLANT INLET		1
16	MA7516	OIL SEAL	30*45*5	1
17	MA7517	EXTERNAL CIR CLIP	S-30	1
18	MA7518	LOW SPINDLE GEAR	21T	1
19	MA7519	BUSHING	18*20*11.5	1
20	MA7520	HIGH SPINDLE GEAR	25T	1
21	MA7521	SPACER		1
22	MA7522	INTERNAL CIR CLIP	S-14	1
23	MA5025	BEARING	HK1010	7
24	MA5023	SELECTOR SCREW		2
25	MA5021	SELECTOR TAB		2
26	MA5020	DETENT PIN		2
27	MA5019	SPRING		2
28	MA352S30	E-CLIP	E-3	2
29	MA7529	FIRST SELECTOR FORK		1
30	MA5022	SPRING		2
31	MA7531	SECOND SELECTOR FORK		1
32	MA7532	THRUST WASHER	1024	6
33	MA7533	LAY SHAFT	16T.7T	1
34	MA3512	WOODRUFF KEY	5*5*10	1
35	MA7535	LAY GEAR	S45C	1
36	MA7536	INTERMEDIATE GEAR	20T.30T	1
37	MA7537	WOODRUFF KEY	5*5*50	1
38	MA7538	COUNTERSHAFT PINION	12T	1
39	MA7539	MAIN SHAFT PINION	10T.12T	1
40	MA5036	WOODRUFF KEY	5*5*8	1
41	MA5037	INPUT GEAR	29T	1
42	MA7542	GEAR PLATE		1
43	MA5039	BEARING	6202 2RS	1
44	MA7544	ARMATURE	220 V	1
45	MA5039	BEARING	6200 2RS	1
46	MA7546	STATOR	220 V	1
47	MA5043	MOTOR HOUSING		1
48	MA3579	CABLE CLAMP		2
49	MA5052	WIRE CONNECTOR	C4	4
50	MA3577	NUT	M4	10
51	MA5049	SCREW	M4*10	2
52	MA3538	SCREW	M4*12	4
53	MA5047	BRUSH SPRING		2
54	MA5046	CARBON BRUSH SET	7*17	2
55	MA5045	BRUSH HOLDER	7*17	2
56	MA5050	MOTOR TAIL COVER		1
57	MA5051	SCREW	4*20	4
58	MA7558	MOTOR CABLE		1
59	MA5059	CABLE PROTECTOR		1
60	MA3579	CORD CLIP		2
61	MA5054	SCREW	M4*16	2
62	MA7562	WIRE LEADS		2
63	MA7563	MOTOR COVER PLATE		1
64	MA5056	SCREW	M5*10	4
65	MA3544	THUMB SCREW		1
66	MA3545	FLAT WASHER	M5	1

MAGPRO 75/4s

67	MA3546	COOLANT TANK BRACKET		1
68	MA3547	COOLANT TANK	400CC	1
69	MA3548	Brass Nut		1
70	MA3549	FLAT WASHER	10 x 32 x 2	1
72	MA3551	COOLANT VALVE		1
73	MA3552	COOLANT TUBE		1
74	MA7574	SLIDE PLATE		1
75	MA5016	WOODRUFF KEY	M4*4*30	1
76	MA5070	CAP BOLT	M8*20	3
77	MA7577	GEAR RACK		1
78	MA3556	CAP BOLT	M8*16	5
79	MA7579	REVERSING SWITCH	220 V	1
80	MA3560	MAGNET SWITCH	220 V	1
81	MA3575	SCREW	M4*12	3
82	MA5080	GUARD BAR		2
83	MA7583	SWITCH PANEL		1
84	MA5083	FLAT WASHER	M4	4
85	MA5084	SPRING WASHER	M4	4
86	MA5085	CAP BOLT	M4*16	4
87	MA5086	MOTOR SWITCH	220V	1
88	MA35K75	SUN WASHER	M5	1
89	MA3506	SPRING WASHER	M8	4
90	MA5078	FLAT WASHER	ψ40*8*2.5	1
91	MA5077	BUSHING	32*38*12	2
92	MA5073	STAND BODY		1
93	MA5074	SET SCREW	M5*25	6
94	MA3569	NUT	M5	6
95	MA5088	GIB STRIP-LEFT		1
96	MA5089	GIB STRIP-RIGHT		1
97	MA5090	GIB STRIP TENSIONER		1
98	MA7598	MAGNET BASE	220 V	1
99	MA3578	SPRING WASHER	M6	3
100	MA75100	CAP BOLT	M6*20	3
101	MA5087	SCREW	M4*25	5
102	MA50103	CABLE GLAND		1
103	MA3584	STRAIN RELIEF		1
104	MA3585	CORD ARMOR		1
105	MA50106	POWER SUPPLY CABLE	220 V	1
106	MA3581	RECTIFIER & EMC	220 V	1
107	MA5094	WIRE LEADS		4
108	MA5095	WIRE LEADS		2
109	MA5096	SIDE COVER		1
110	MA3557	SCREW	M4*8	4
111	MA50100	CRANK SPINDLE		1
112	MA5098	CRANK HANDLE		3
114	MA75114	WIRE CONNECTOR		2
115	MA75115	ARBOR SUPPORT BRACKET		1
116	MA75118	CAP BOLT	M8*25	3
117	MA75117	TRAVEL STOP		1
118	MA75118	CAP BOLT	M6*40	1
119	MA5004	SCREW	M4*6	2
120	MA3505	BEARING	HK3516	1
121	MA50109	CHIP GUARD		1
122	MA3592	SAFETY CHAIN		1
123	MA3590	BUTTERFLY SCREW	M6*10	2
124	MA3589	FLAT WASHER	M6	2
125	MA3593	WRENCH	M8	1
126	MA3594	HEX. KEY	M2-5	1
127	MA3595	HEX. KEY	M4	1
128	MA75128	DRIFT		1
129	MA50114	OVER LOAD PROTECTON	220 V	1
132	MA351S127	RUBBER WASHER	ψ4 x ψ11 x 1	1
137	MA5051	SCREW	M4 x 20	2
142	MA351S108	SCREW	M4 x 25	3
	MA75BOX	PLASTIC BLOW CASE		1